

Outdoor • Day/Night • Weather-proof

**NETWORK CAMERA**

# Quick Installation Guide

English | 繁體中文 | 简体中文 | 日本語 | Français | Español | Deutsch | Português | Italiano | Türkçe | Polski | Русский | Český | Svenska | العربية



## IP7330

This guide describes the basic functions of IP7330.

All detailed information is described in the user's manual.



## Warning Before Install

- **Power off the Network Camera as soon as it is found smoking or smelt unusual.**
- **Refer to your user's manual for the operating temperature.**



Contact your distributor when such cases happen.

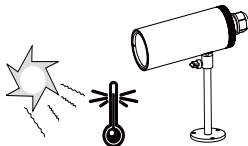

- **Do not place the Network Camera on unsteady surfaces.**
- **Do not touch the Network Camera when it's lightning.**

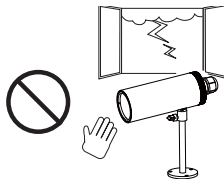
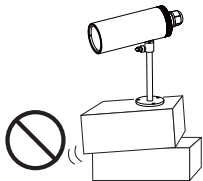

- **Do not insert any object into the Network Camera, such as needles.**
- **Do not drop the Network Camera.**

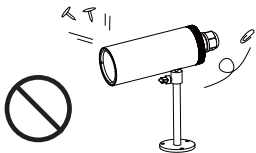

# 1

## Package Contents

### ● IP7330

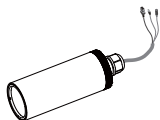

### ● Liquid tight connectors (3 holes, for backup use)



### ● Silica gel



### ● Camera stand

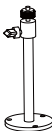

### ● Power adapter



### ● RJ45 female/female coupler

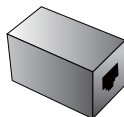

### ● Quick installation guide / Warranty card



### ● Software CD



## 2 Physical Description

### ● Front panel

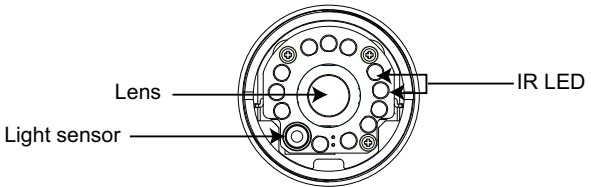

### ● Back panel

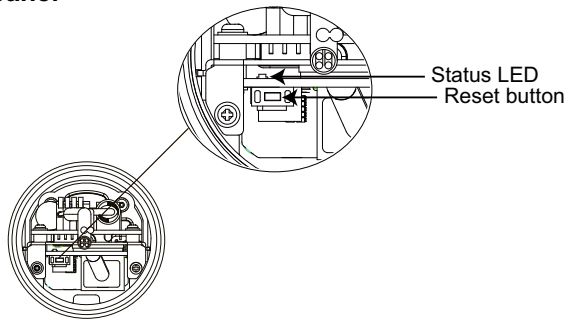

### ● Connectors

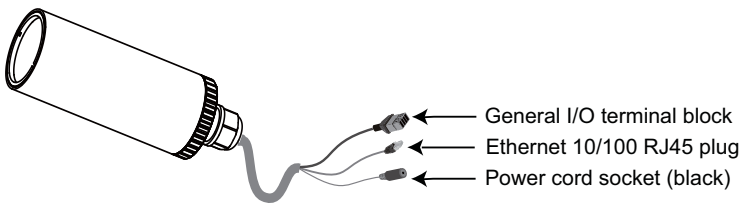

## 3

## Hardware Installation

1. Loosen the liquid tight connectors, and then remove the rubber.
2. Loosen the back cover.
3. Tear down the aluminum foil vacuum bag and take out the silica gel. Attach the supplied silica gel to the inner side of the Network Camera. (Please replace the silica gel with a new one if you open the back cover after installation.)
4. Make sure all cable lines are securely connected.
5. Tighten the back cover, rubber and liquid tight connectors.
6. Secure the Network Camera to the wall/ceiling by the supplied camera stand.

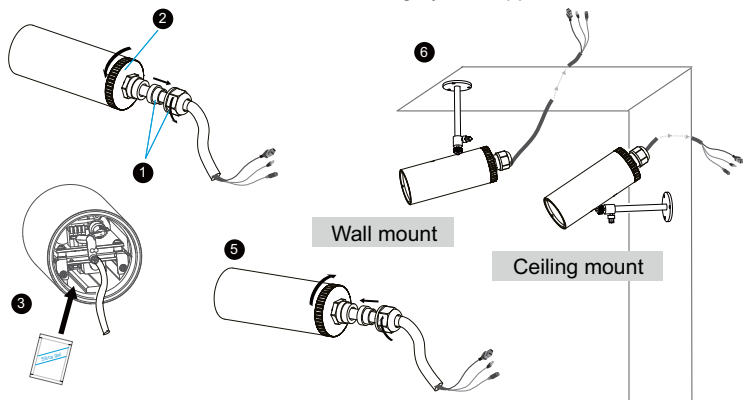
**Note**

If you want to use your own cable lines, please loose two supplied screws and take out the power board. Then be careful to make connections as the illustration below.

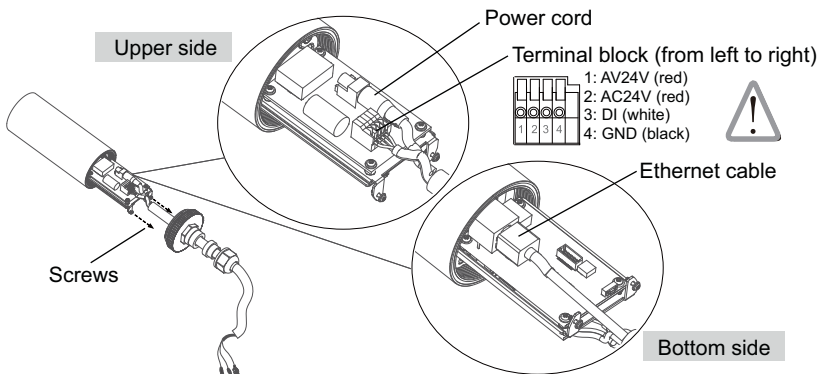

## 4 Network Deployment

### General Connection (without PoE)

1. If you have external devices such as sensors and alarms, make connections from general I/O terminal block.



AV24V: 24V+  
 AC24V: 24V-  
 DI : Digital Input  
 GND : Ground

2. Use the supplied RJ45 female/female coupler to connect the Network Camera to a switch.  
 Use Category 5 Cross Cable when Network Camera is directly connected to PC.

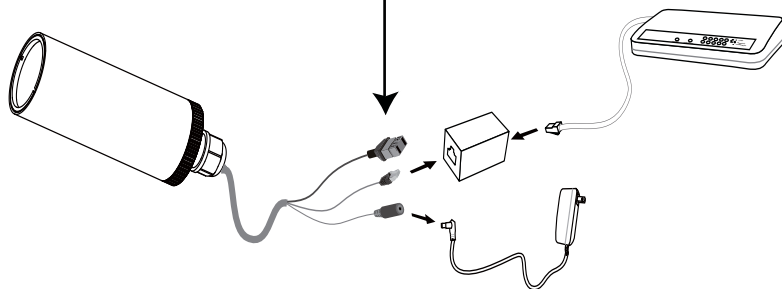

3. Connect the power cable from the Network Camera to a power outlet.

## **Power over Ethernet (PoE)**

### **● When using a PoE-enabled switch**

The Network Camera is PoE-compliant, allowing transmission of power and data via single Ethernet cable. See the following illustration to connect the Network Camera to a PoE-enabled switch via Ethernet cable.

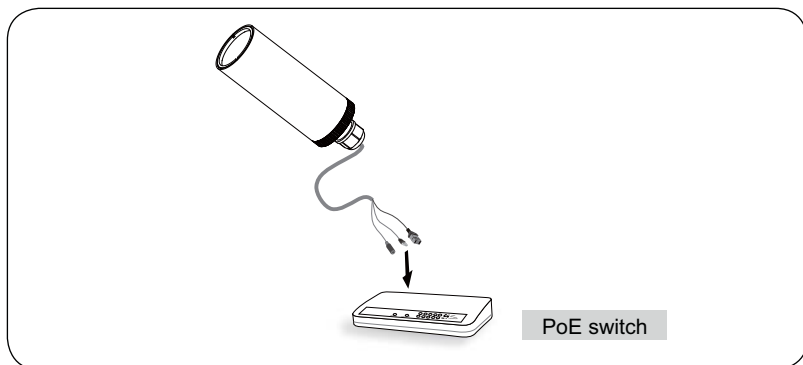

### **● When using a non-PoE switch**

Use a PoE power injector (optional) to connect between the Network Camera and a non-PoE switch.

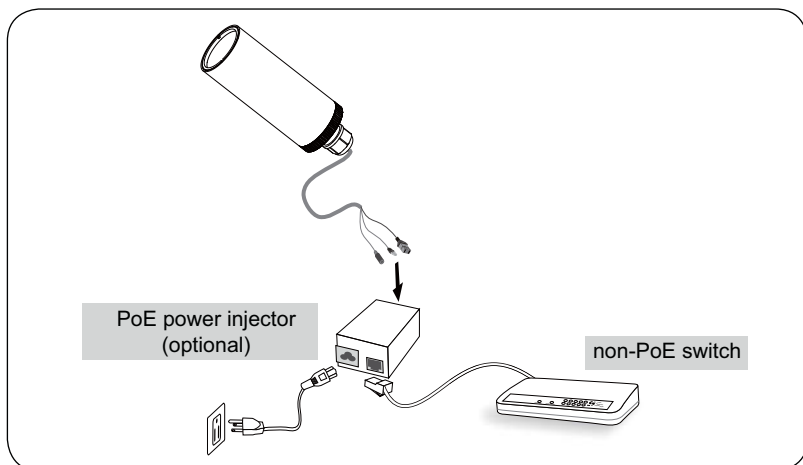

## 5 Assigning IP Address

1. Install the "Installation Wizard 2" under the Software Utility directory from software CD.
2. The program will conduct analyses on your network environment. After your network is analyzed, please click on the "Next" button to continue the program.



3. The program will search the VIVOTEK Video Receivers, Video Servers or Network Cameras on the same LAN.
4. After searching, the main installer window will pop up. Click on the MAC that matches the one labeled on the bottom of your device to connect the Internet Explorer to the Network Camera.



## 6

## Ready to Use

1. Access to the Network Camera from the Internet.
2. Retrieve live video through web browsers or recording software.



For further setup, please refer to user's manual on the software CD.



P/N:625008100G Ver.1.0  
Copyright © 2009 VIVOTEK INC. All rights reserved.